

# AIIM

## Angel Island Immigration Museum Ribbon-Cutting Ceremony

Saturday, January 22, 2022





## Welcome

Edward Tepporn | AIISF Executive Director  
Buck Gee | AIISF Board President

## Opening Remarks

Secretary Wade Crowfoot | California Natural Resources Agency  
Director Armando Quintero | California State Parks

## Introduction to AIIM

Rosemarie Nahm | AIISF Board Vice President  
Preview Video from Felicia Lowe

## Awards Presentation

AIISHAC | Immigrant Heritage Award  
Ranger Alexander Weiss | Spirit of Angel Island Award

## Performance

"Half & Halves" by Duniya Dance and Drum Company  
and Ensembles Ballet Folklorico de San Francisco

## Remarks

Assemblymember Phil Ting | California State Assembly  
David Chiu | City Attorney of San Francisco

## Ribbon-Cutting

Director Quintero and Buck Gee

## Closing Remarks

Felicia Lowe | Event Co-Chair  
Edward Tepporn | AIISF Executive Director

## Performance

"Symposium" from San Jose Taiko's  
45th Anniversary Concert







## Angel Island State Park

Angel Island, the largest island in San Francisco Bay, is a park dedicated to the preservation of the island's abundant natural and cultural resources.

In 1954, the California State Park Commission acquired Ayala Cove. In the following months, Parks acquired additional acreage above the cove. In 1962, the island was turned over to the California Department of Parks and Recreation.

Prior to its designation as a California State Park, Angel Island served an array of functions. For thousands of years the island was used as a fishing outpost by the Coast Miwok.

In 1910, the Angel Island Immigration Station opened. During its thirty years in service approximately 500,000 immigrants from Asia, Europe, and South America passed through Angel Island.

In the 1970s, Chinese poetry was rediscovered in the Immigration Station barracks. Since then, Angel Island State Park has become a popular destination for genealogical research, for discovering the history of immigration on the West Coast, and has remained a popular site for recreation.



## Angel Island Immigration Museum

AIIM is a place where visitors can explore the full complexity of immigration to the United States through the Pacific Coast. Housed in the former immigration hospital, the museum presents personal stories, immigration policies, and social issues from both historic and contemporary times.

The exhibits draw upon the diversity of Angel Island's history by highlighting stories of immigrants from China, Korea, Vietnam, Russia, Japan, India, Mexico, the Philippines, and more.

Whether it's the topic of undocumented immigration, medical exclusion, ethnic quotas, or picture brides, the AIIM invites consideration of immigration issues and celebrates the accomplishments of immigrants living in America today.

Thanks to generous funding from federal and state governments and private donations from AIISF supporters, much of the immigration station site and the detention barracks were restored and reopened in 2009.

AIIM bookends the 40 years of restoration efforts and will offer new exhibits, programs, and educational opportunities for the public.





## Angel Island Immigration Station Historic Advisory Committee (AIISHAC) Immigrant Heritage Award Honoree

In 1970, the Angel Island Immigration Station was slated for demolition because of its deteriorated condition; but the discovery of Chinese poetry that had been carved into the walls of the detention barracks saved it from destruction and led to renewed interest in the Angel Island Immigration Station. Most importantly, the discovery of poetry increased awareness of the need to access the vivid lessons of sacrifice and triumph in the history of immigration.

Sparked by the discovery, Paul Chow, Chris Chow, Connie Young Yu, and other members of the Asian American community formed AIISHAC. The organization studied how best to preserve the station for historical interpretation. In July 1976, their hard work came to fruition as the state legislature appropriated \$250,000 to restore and preserve the Immigration Station as a state monument.

The barracks opened to the public in 1983, and members of AIISHAC created the Angel Island Immigration Station Foundation (AIISF) to continue preservation and educational efforts for the site and increase awareness of the contributions of Pacific Coast immigrants.



*"It was part of my job to go around and see what's going on around the Island. So, I went to see the Immigration Station with a flashlight. And I noticed that even though it wasn't open to the public, I noticed these carvings. In fact, I was amazed; it was everywhere."*

- Alexander Weiss



## **Ranger Alexander Weiss**

### **Spirit of Angel Island Award Honoree**

From his family's escape from Austria in 1940 to his days as a Freedom Rider; and from growing up in the Fillmore during its early jazz days to his involvement at Hearst Castle and Natural Bridges State Parks, Weiss has been a nonconformist, most often to the public's benefit.

In 1970, Alex became a park ranger on Angel Island. That same year, he discovered Chinese writing on the walls of the detention barracks. Although the former Immigration Station was scheduled for demolition, Alex reached out to his professor at San Francisco State University and a movement to save the site was born.

After Angel Island, Alex continued his work with the California State Parks, the San Francisco Zoo, and Alameda County Registrar of Voters until his retirement in 2009.

AIISF presents this award to Alexander Weiss' wife, Carol Ellison, in memory of his service and vision.

## Immigrant Dreams Sponsors

Buck Gee & Mary Hackenbracht  
Eric Yuan  
Akiko Yamazaki & Jerry Yang  
Southwest Airlines

## Hero Voices Sponsors

Douglas & Kathy Ko Chin  
Rosemarie & Tae Hea Nahm

## Heritage Sponsors

Milton Chen & Ruth Cox / W.K. Kellogg Foundation  
Claudine Cheng  
Henry & Priscilla Der  
Look Lowe Family Trust  
Sonny & Jennifer Lulla  
Katherine Toy & Tony Tam

## Legacy Sponsors

Darlene Chiu Bryant  
Win Chang  
Dr. Gary W. & Nobuko Saito Cleary  
Natalie Huen  
Bassie Lee  
Jonathan & Willa Leong  
Richard Lui  
RADM (ret) Pamela Schweitzer, USPHS & Mr. Paul Schweitzer  
Ed Tepporn & Dean Leri

AIISF is honored to extend its deep appreciation to the donors who helped us restore the former immigration hospital and made the Angel Island Immigration Museum possible.

[www.aiisf.org/aiimdonors](http://www.aiisf.org/aiimdonors)



## Second Floor

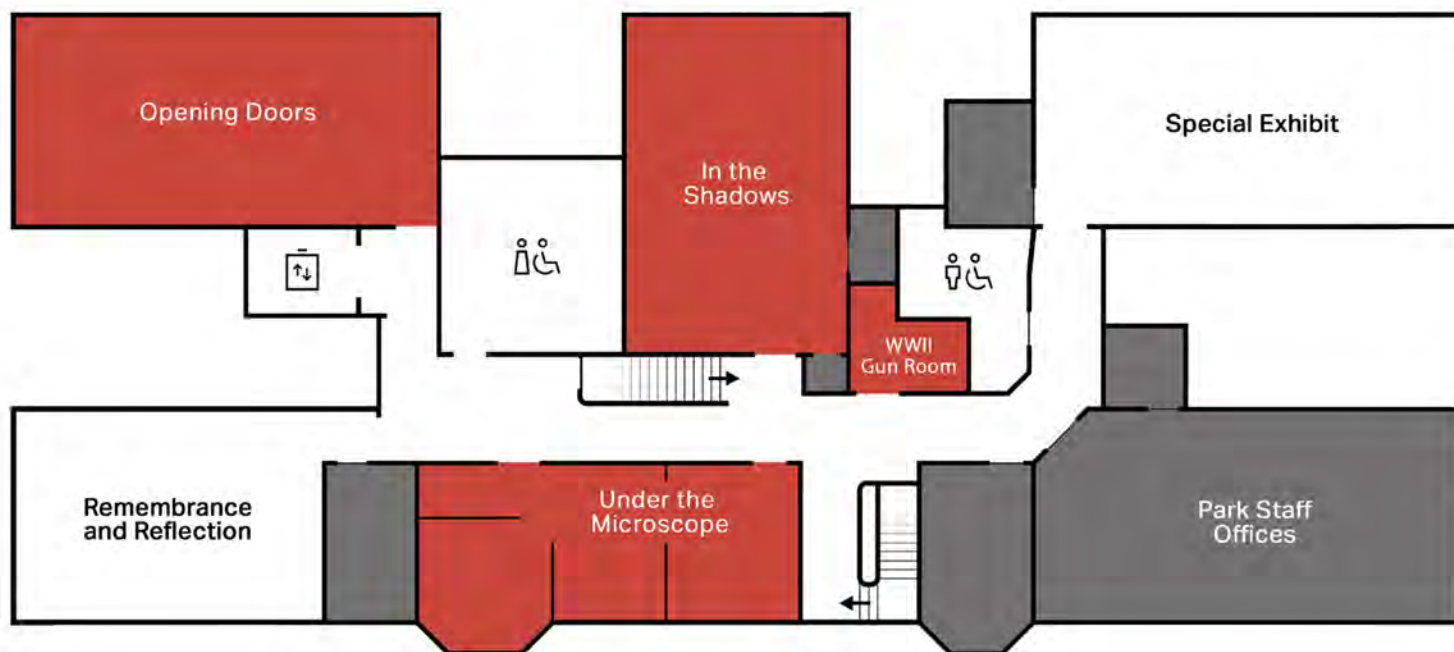

## First Floor

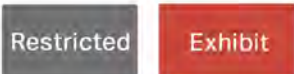
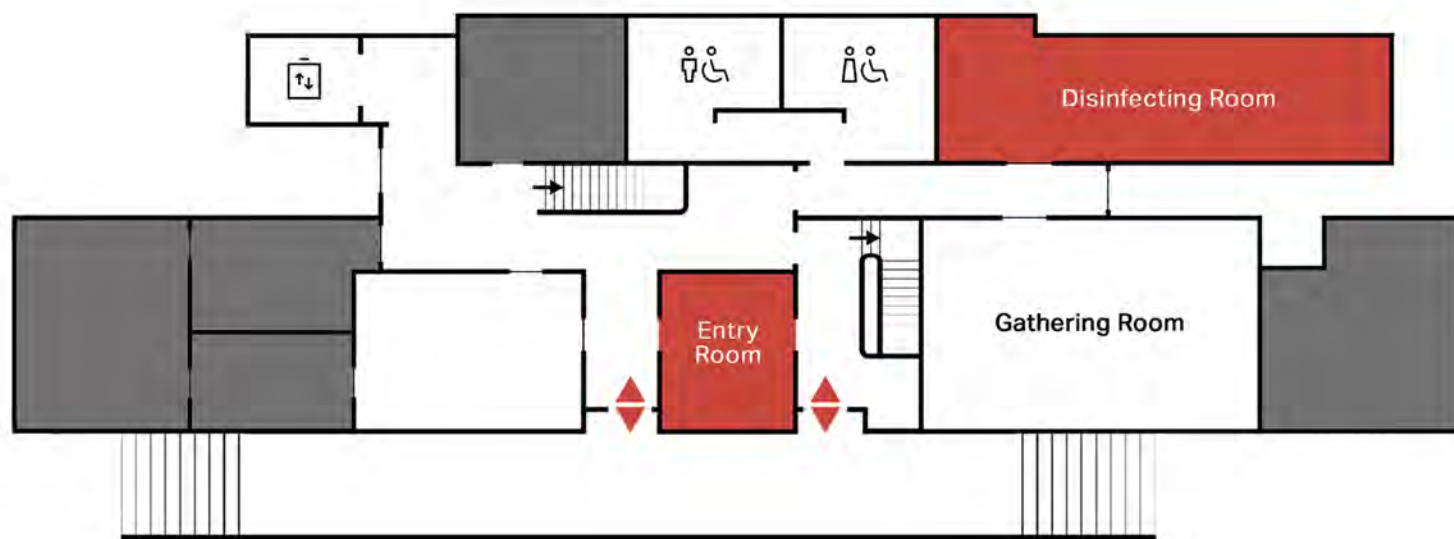

## Opening Doors



Opening Doors is about hope, pursuing new opportunities, and immigrant contributions. The exhibit reveals how immigration policies were pivotal turning points for generations of the past and continue to shape citizenship today.

## In the Shadows



In The Shadows is about overcoming exclusion and enduring detention. A diverse range of historical and contemporary stories explores the impact of divisive laws on individual lives and American culture.

## Under the Microscope



Under the Microscope focuses on the medical theories and that impacted immigration enforcement in the early 20th century. When contemplating health regulations, questions about responsibility, control, compassion, and safety arise.

Opening AIIM completes stage one of the hospital project. There are several rooms inside the museum that are not yet furnished. If you are interested in contributing to the future of AIIM, you can make a donation at [www.aiisf.org/donate](http://www.aiisf.org/donate).

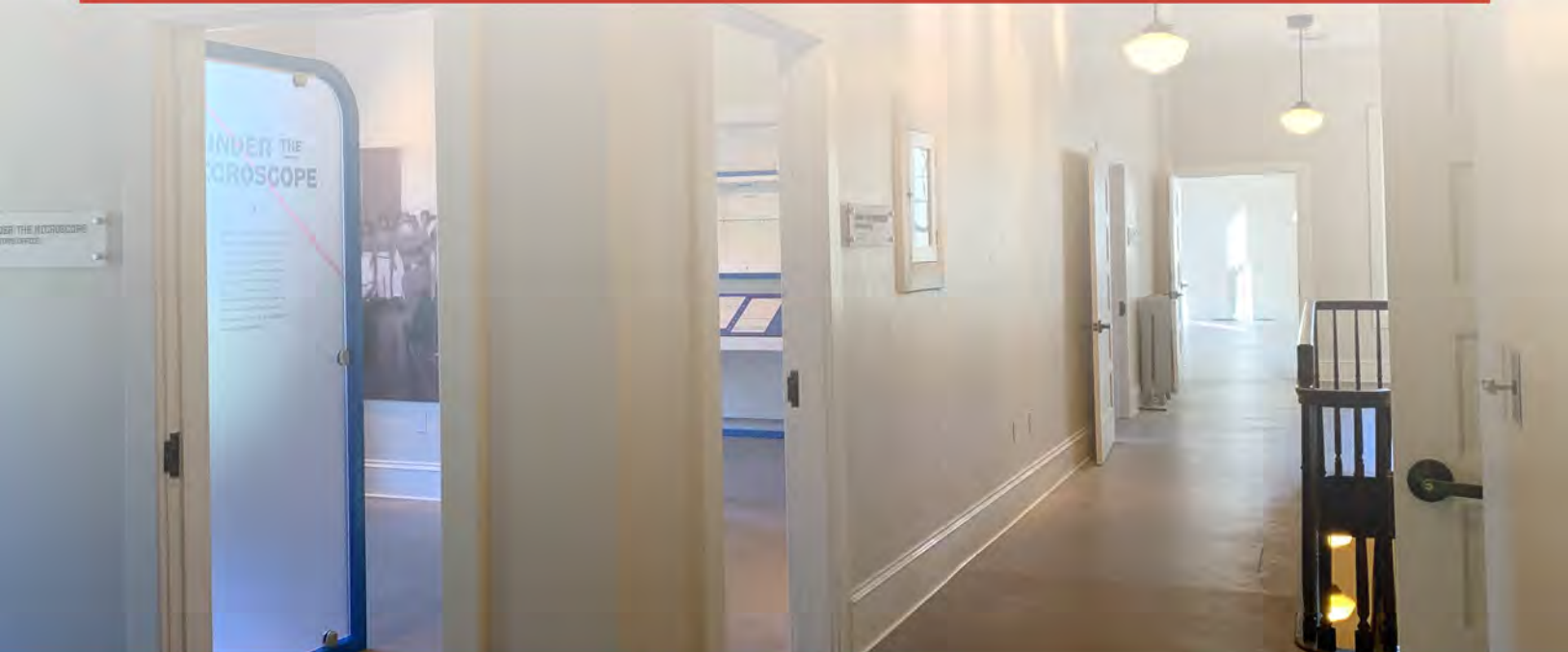



# AIIM

Angel Island Immigration Museum

## About AIISF

Angel Island Immigration Station Foundation (AIISF) raises awareness of the experience of Immigration into America through the Pacific. AIISF collects and preserves the rich stories and personal journeys of thousands of immigrants and shares them with visitors and everyone living in America through education initiatives and public programs. The Angel Island Immigration Station reminds us of the complicated history of immigration in America. It serves as a symbol of our willingness to learn from our past to ensure that our nation keeps its promise of liberty and freedom.

## AIISF Board of Directors

Buck Gee, President

Rosemarie Nahm, Vice President

Darlene Chiu Bryant, Secretary

Dien Yuen, Treasurer

Win Chang

Paul Chin

Nobuko Saito Cleary

Natalie Huen

Richard Lui

Sunny Lulla

Sameen Piracha

Thomas Tolentino

## AIISF Staff

Edward Tepporn, Executive Director

Russell Nauman, Operations Manager

### Angel Island Immigration Museum Virtual Exhibition

The virtual exhibition provides a deeper exploration of the topics discussed in AIIM while providing additional content and resources that can be accessed from home.

[www.aiisf.org/aiimexhibit](http://www.aiisf.org/aiimexhibit)



ANGEL ISLAND IMMIGRATION STATION FOUNDATION  
870 Market Street, Suite 941, San Francisco, CA 94102